

# Kit 1350

TOYOTA Hilux, 4-dr Double Cab, 05–  
TOYOTA Vigo, 4-dr Double Cab, 04–

480R  
754

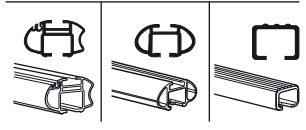
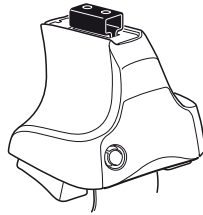

480

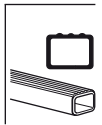
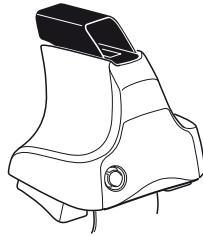

750

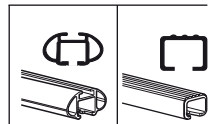
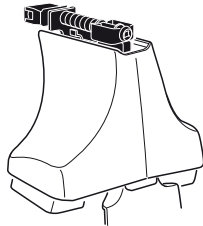

**Kit**



3



754

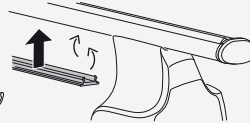
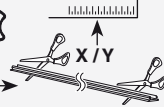

750



1

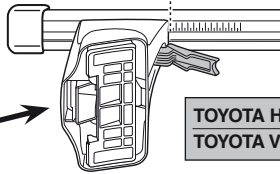
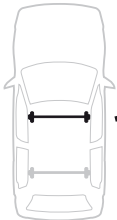

2

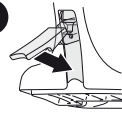

	X
TOYOTA Hilux, 4-dr Double Cab, 05–	41,5
TOYOTA Vigo, 4-dr Double Cab, 04–	41,5

1

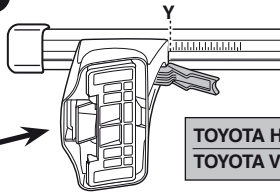
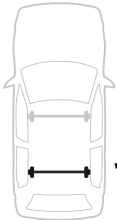

2

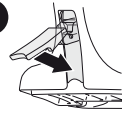

	Y
TOYOTA Hilux, 4-dr Double Cab, 05–	42
TOYOTA Vigo, 4-dr Double Cab, 04–	42



480R



480

1

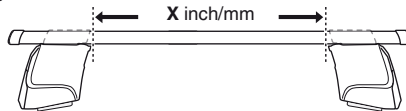

2

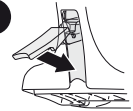

	X inch	X mm
TOYOTA Hilux, 4-dr Double Cab, 05–	42"	1066 mm
TOYOTA Vigo, 4-dr Double Cab, 04–	42"	1066 mm

1

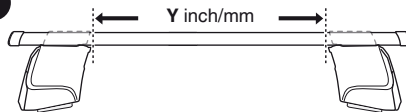

2

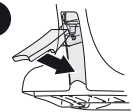

	Y inch	Y mm
TOYOTA Hilux, 4-dr Double Cab, 05–	42 1/8"	1071 mm
TOYOTA Vigo, 4-dr Double Cab, 04–	42 1/8"	1071 mm

# 4

TOYOTA Hilux, 4-dr Double Cab, 05–  
 TOYOTA Vigo, 4-dr Double Cab, 04–

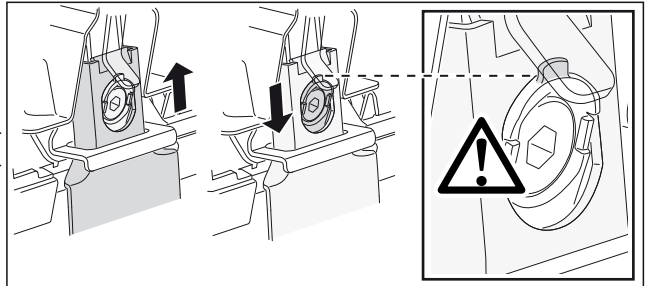
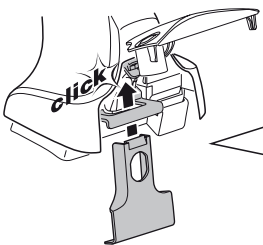
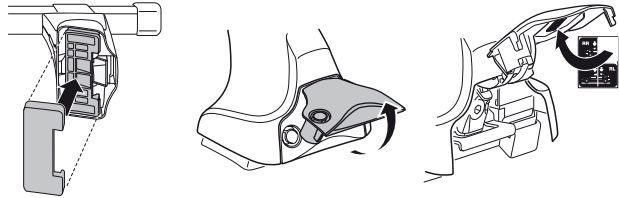
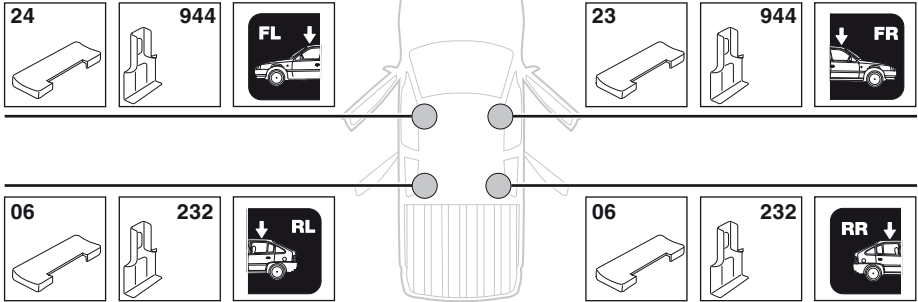

5

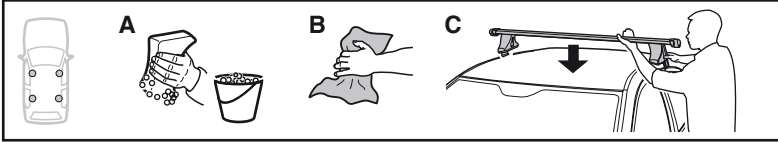

	X mm	Y mm	X inch	Y inch
TOYOTA Hilux, 4-dr Double Cab, 05-	250 mm	720 mm	9 7/8"	28 3/8"
TOYOTA Vigo, 4-dr Double Cab, 04-	250 mm	720 mm	9 7/8"	28 3/8"

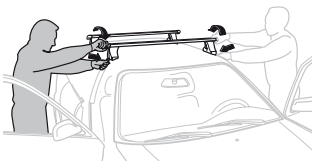
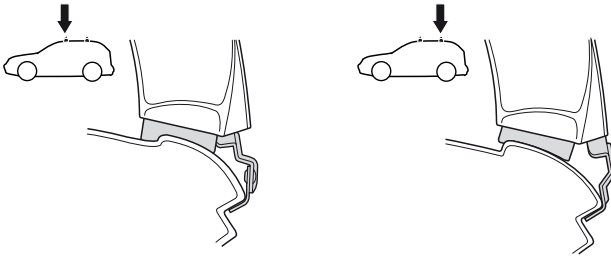
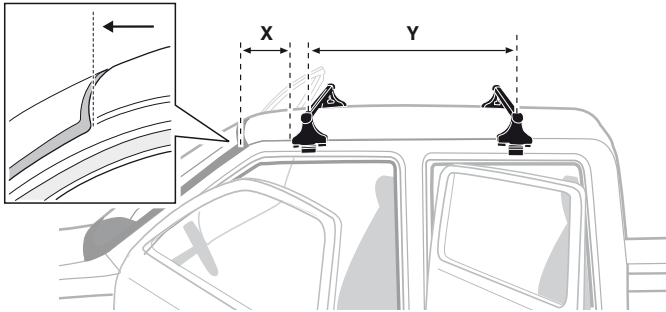

- |              |                                                         |            |                                                     |
|--------------|---------------------------------------------------------|------------|-----------------------------------------------------|
| <b>GB/US</b> | Tighten alternately                                     | <b>CZ</b>  | Pokřetla bagazníka dokřečaj dokřečaj napřezmiennie. |
| <b>D</b>     | Die Schrauben abwechselnd anziehen                      | <b>SK</b>  | Dotahujte striedavo                                 |
| <b>F</b>     | Serrer alternativement chaque côté                      | <b>SLO</b> | Privijajte izmenično.                               |
| <b>NL</b>    | Afwisselend aan de linker- en de rechterkant aandraaien | <b>HR</b>  | Naizmjenično zategnite                              |
| <b>I</b>     | Alternare il serraggio delle viti                       | <b>HU</b>  | Egy mástól függetlenül szorítandó                   |
| <b>E</b>     | Apretar alternativamente                                | <b>GR</b>  | Σφιγγετε εναλλάξ                                    |
| <b>PT</b>    | Aperte alternadamente                                   | <b>TR</b>  | Dönüşümlü sıkın                                     |
| <b>S</b>     | Dra åt växelvis                                         | <b>中文</b>  | 交替拧紧                                                |
| <b>FIN</b>   | Kierrä vuorotellen                                      | <b>한국어</b> | 번갈아 가며 조이십시오.                                       |
| <b>EST</b>   | Pinguldage vaheldumisi                                  | <b>日本語</b> | 交互に締め付けてください。                                       |
| <b>LAT</b>   | Pievelciēt pamīšus                                      | <b>ไทย</b> | ขันในแบบสลับ                                        |
| <b>LIT</b>   | Užsukinėkite pakaitomis                                 |            |                                                     |
| <b>PL</b>    | Śruby dokręcaj naprzemiennie                            |            |                                                     |
| <b>RU</b>    | Затягивайте попеременно                                 |            |                                                     |

6



480R/754



480

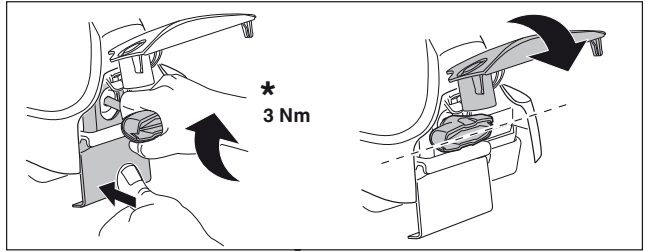
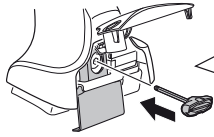

\*  
3 Nm



\*

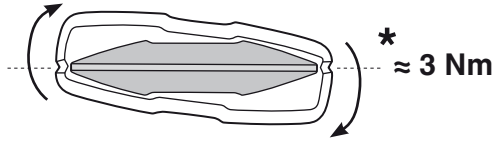

\*  
≈ 3 Nm

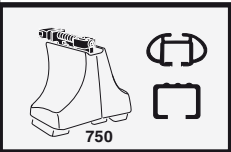
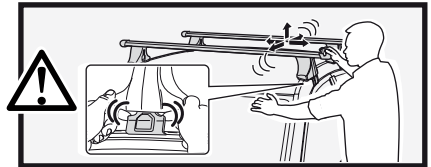

750

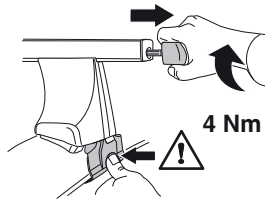

4 Nm

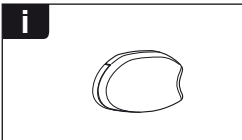
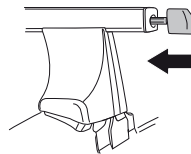

i

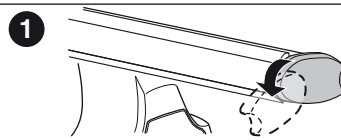

1

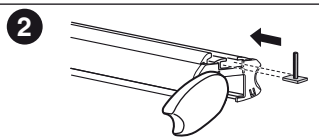

2

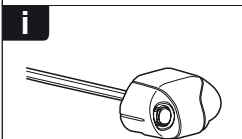

i

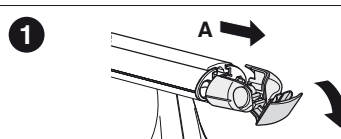

1

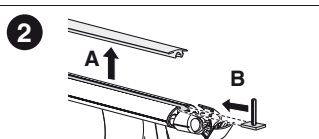

2

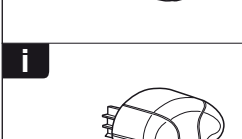

i

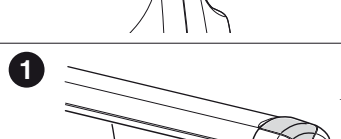

1

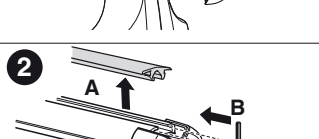



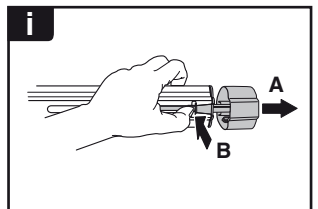
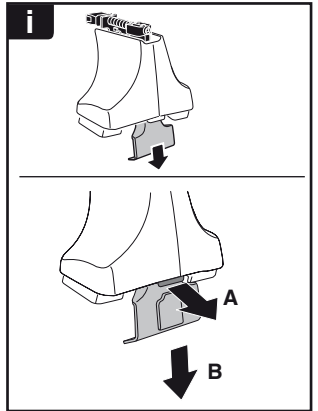

2



**THULE**  
SWEDEN  
**ONE  
KEY  
SYSTEM**



-  **544** (x4)
-  **596** (x6)
-  **588** (x8)
- NA**  **510** (x10)
- EUR**  **452** (x12)
- ASIA**



**WW** ▶ Thule Sweden AB, Box 69, 330 33 Hillerstorp, SWEDEN  
**NA** ▶ Thule Inc., 42 Silvermine Road, Seymour, Connecticut 06483, USA

 info@thule.com  
customer.service@thule.com

 www.thule.com





[www.thuleprofessional.com](http://www.thuleprofessional.com)



[customer.service@thule.com](mailto:customer.service@thule.com)



Thule Inc., 42 Silvermine Road, Seymour, Connecticut 06483, USA  
Thule Sweden AB, Box 69, 330 33 Hillerstorp, SWEDEN

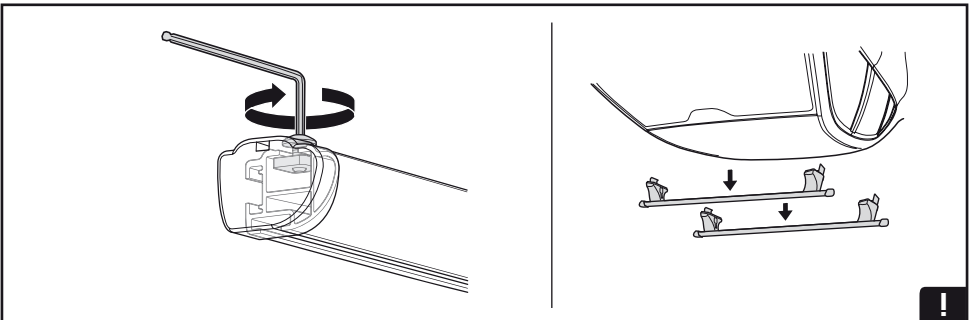
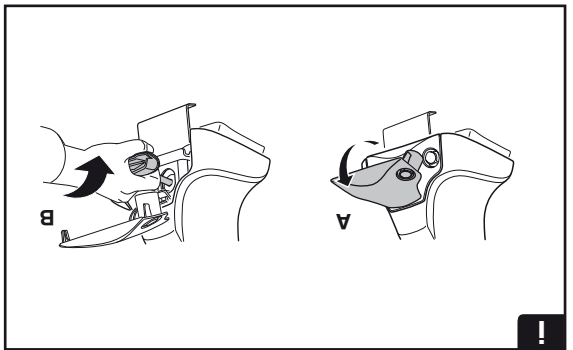
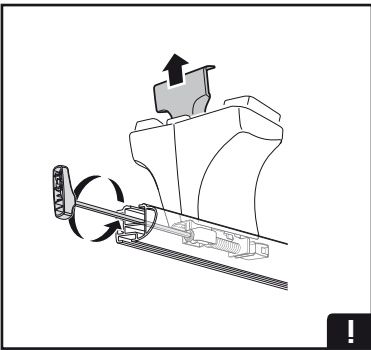
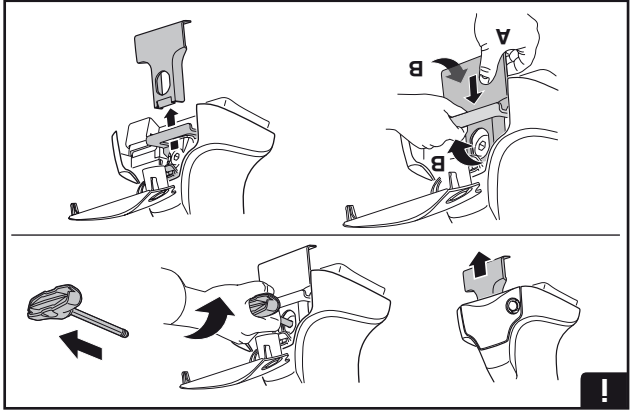
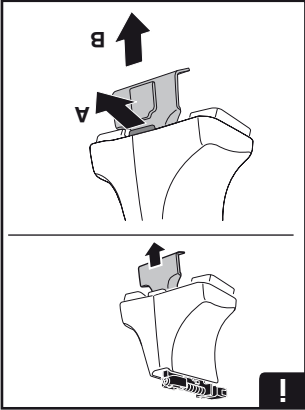

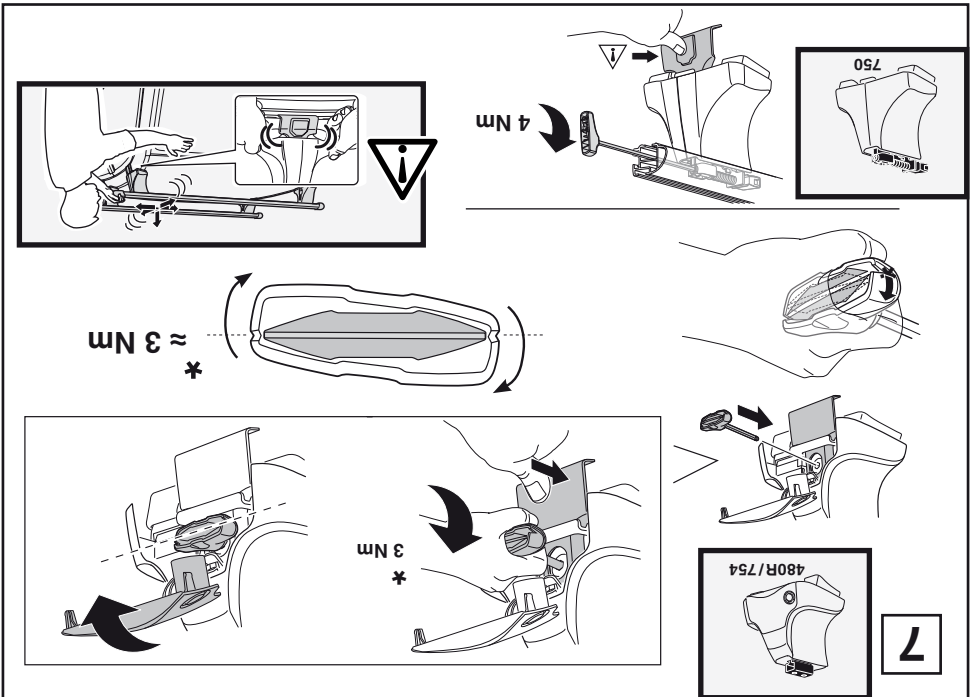
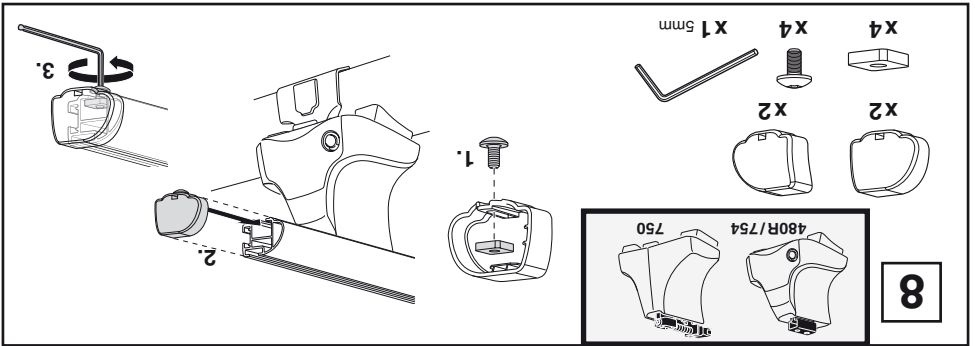
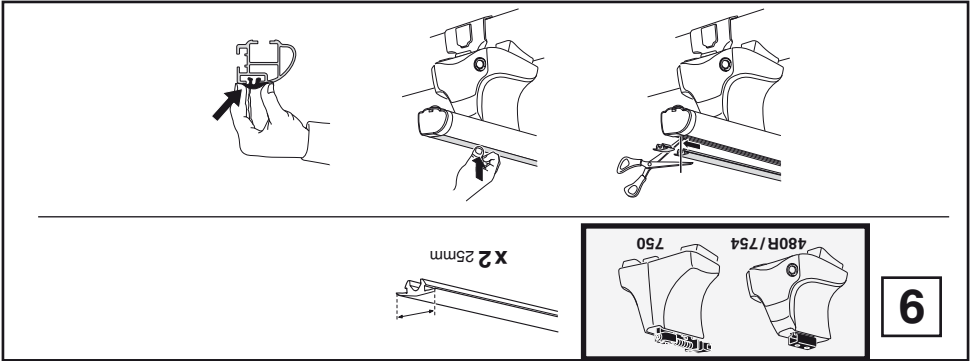

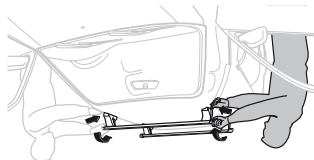

GB/US Tighten alternately  
 D Die Schrauben abwechselnd  
 F anziehen  
 NL Serrer alternatiefment chaque côté  
 I Alternare il serraggio delle viti  
 E Aperte alternativamente  
 PT Aperte alternadamente  
 S Dra åt växelvis  
 FIN Kierrä vuorotellen  
 EST Pinguldage vaheldumisi  
 LAT Pielieciet pamīsus  
 LT Užskinkite pakaitomis  
 PL Słubij dokręcaj naprzemiennie  
 RU Затягивайте попеременно

CZ Pokrétla bezpečně dokręcaj  
 SK Dotahujte striedavo  
 SLO Priljavljajte izmenično.  
 HU Aftwisselend aan de linker- en de rechterkant aandraden  
 NL Atwisselend aan de linker- en de rechterkant aandraden  
 I Alternare il serraggio delle viti  
 E Aperte alternativamente  
 PT Aperte alternadamente  
 S Dra åt växelvis  
 FIN Kierrä vuorotellen  
 EST Pinguldage vaheldumisi  
 LAT Pielieciet pamīsus  
 LT Užskinkite pakaitomis  
 PL Słubij dokręcaj naprzemiennie  
 RU Затягивайте попеременно

日本語 交互に締め付けてください。  
 한국어 가며 조이십시오.  
 中文 交替拧紧

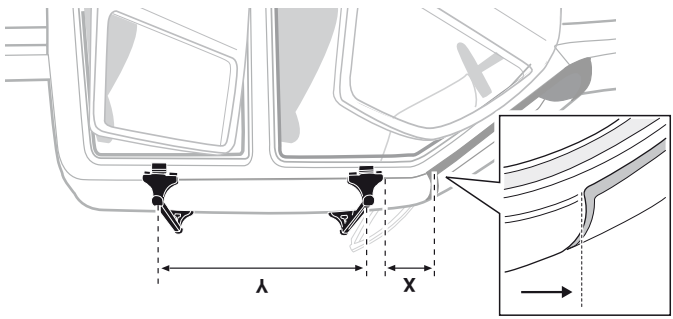
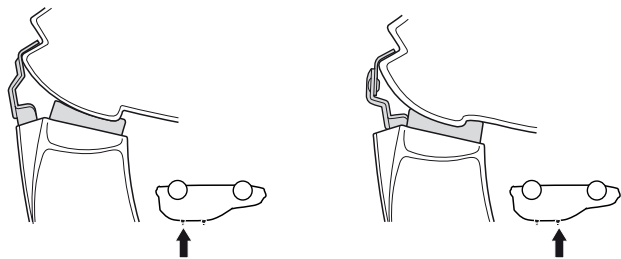

TOYOTA Hilux, 4-dr Double Cab, 05-	250 mm	720 mm	9 7/8"	28 3/8"
TOYOTA Vigo, 4-dr Double Cab, 04-	250 mm	720 mm	9 7/8"	28 3/8"
	X mm	Y mm	X inch	Y inch

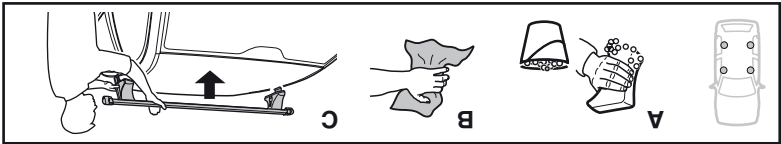

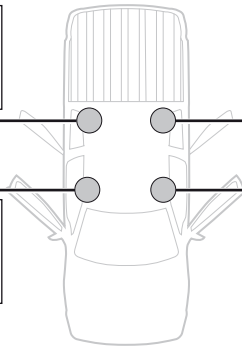
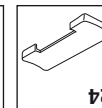
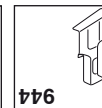
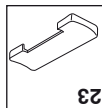
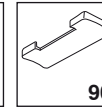
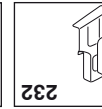
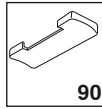
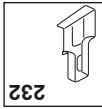
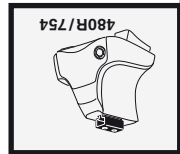
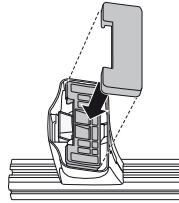
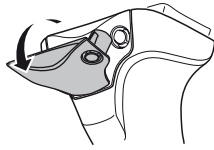
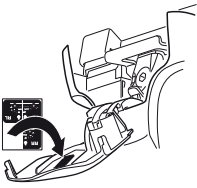
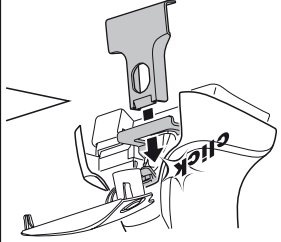
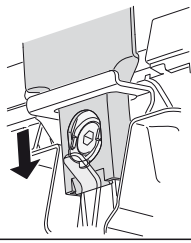
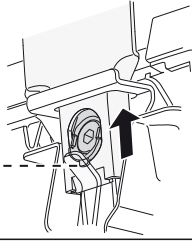
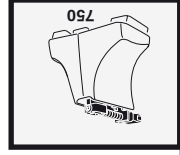
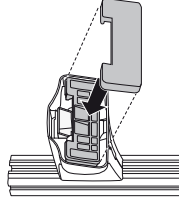
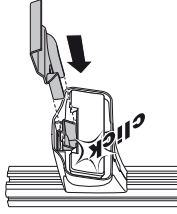
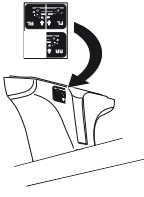

TOYOTA Hilux, 4-dr Double Cab, 05-  
TOYOTA Vigo, 4-dr Double Cab, 04-

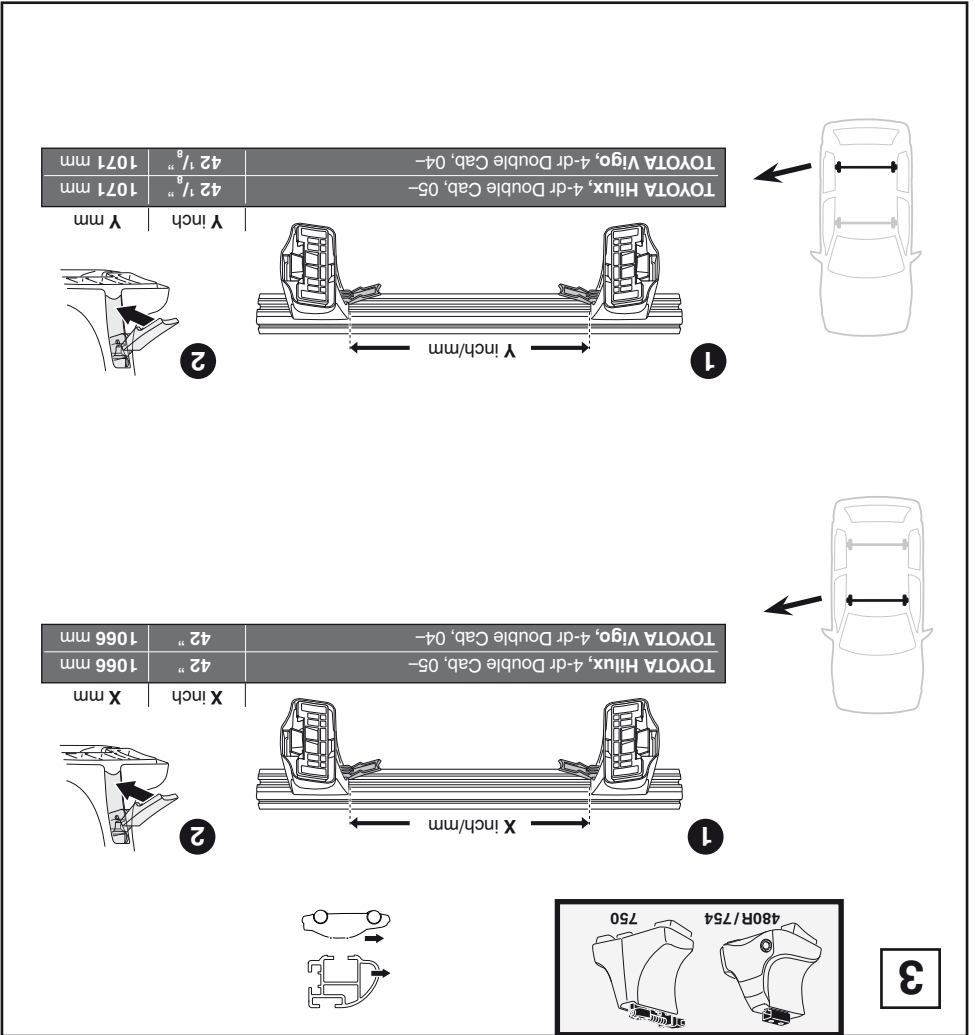
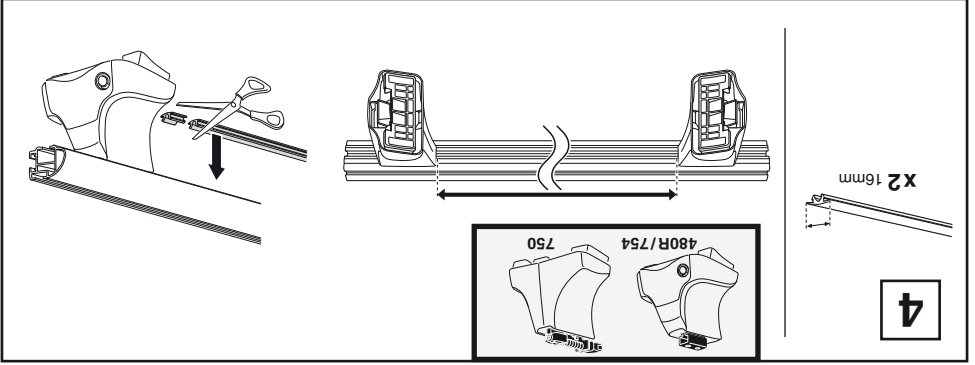

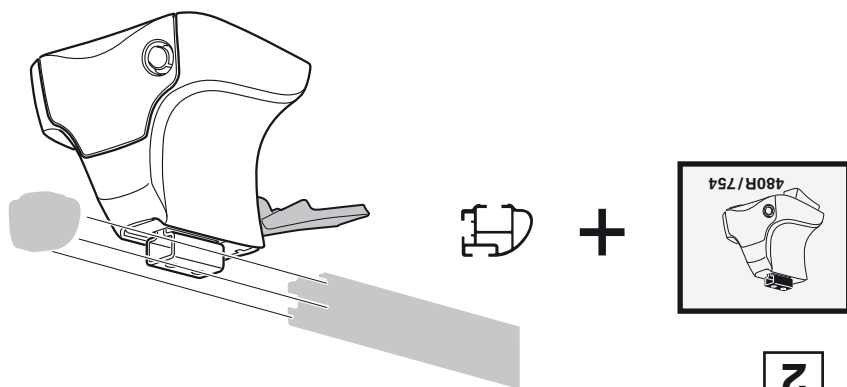
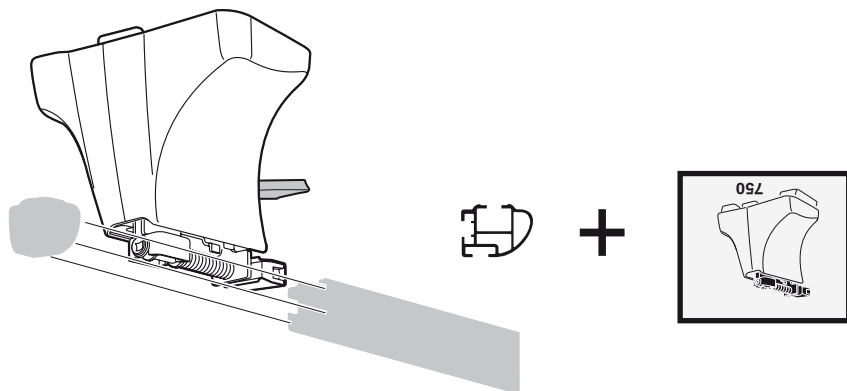

2

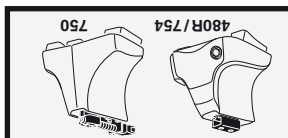
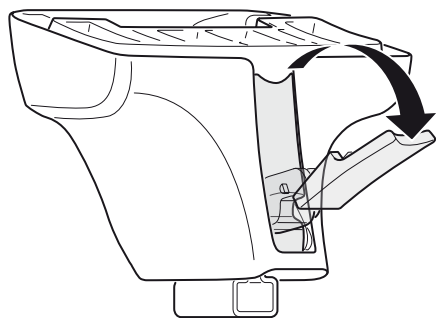

1

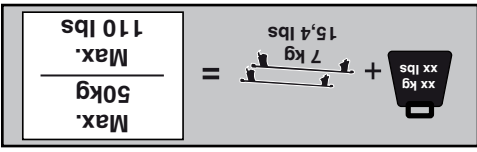
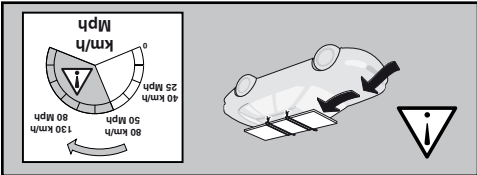
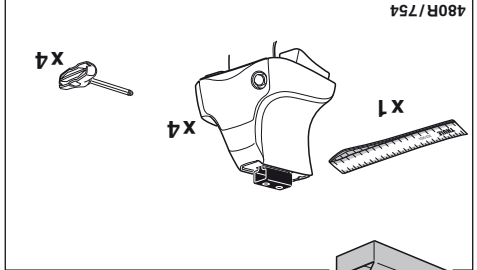
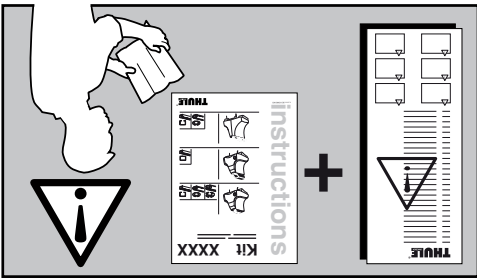
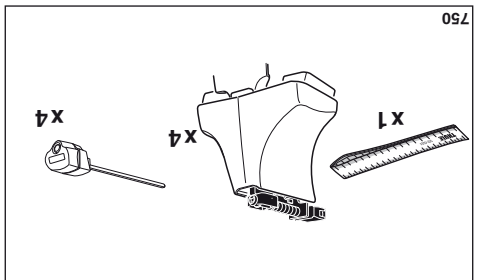
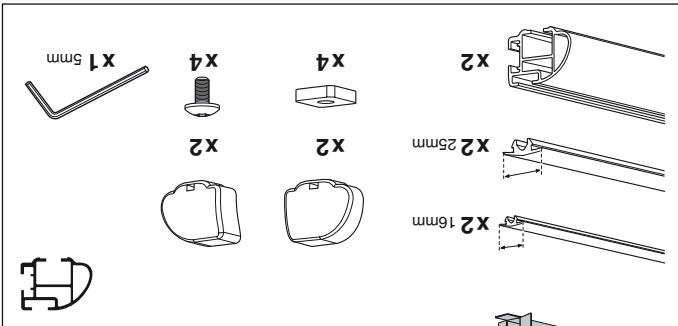
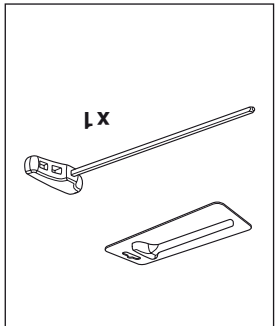
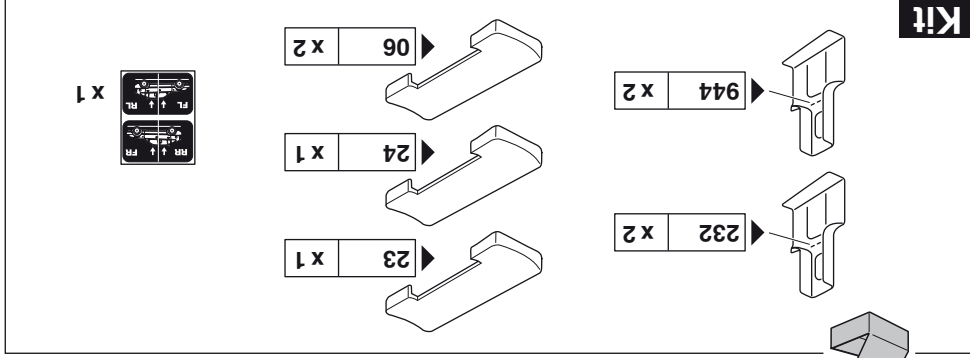

# instructions

# Kit 1350

TOYOTA Hilux, 4-dr Double Cab, 05-  
TOYOTA Vigo, 4-dr Double Cab, 04-

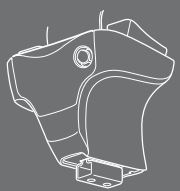

480R  
754

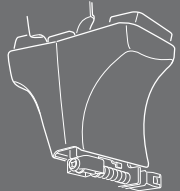
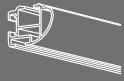

750

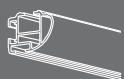

**THULE**  
SWEDEN

PROFESSIONAL

ISO 11154-E