

Kit 1546

LEXUS RX 350, 5-dr SUV, 09-*

LEXUS RX 450h, 5-dr SUV, 09-*

TOYOTA Venza, 5-dr SUV, 09-*

* w/o factory rack

480R
754

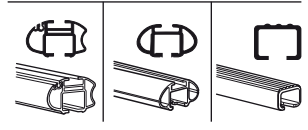
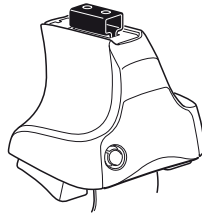

480

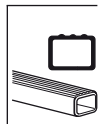
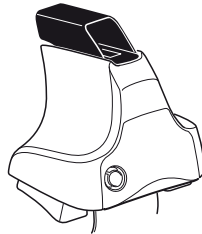

750

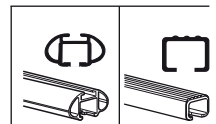
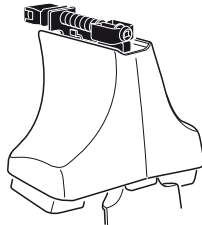

THULE[®]
SWEDEN

Kit



3

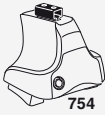

754

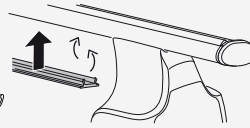
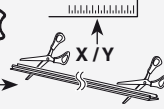

750



1

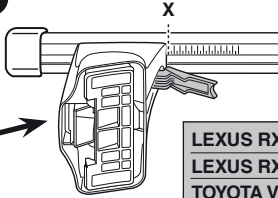
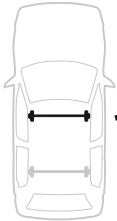

2



	X
LEXUS RX 350, 5-dr SUV, 09–	45
LEXUS RX 450h, 5-dr SUV, 09–	45
TOYOTA Venza, 5-dr SUV, 09–	45

1

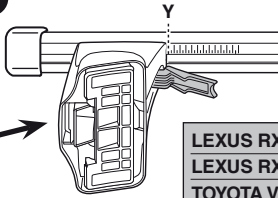
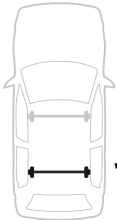

2

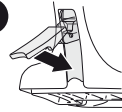

	Y
LEXUS RX 350, 5-dr SUV, 09–	45
LEXUS RX 450h, 5-dr SUV, 09–	45
TOYOTA Venza, 5-dr SUV, 09–	45



480R



480

1

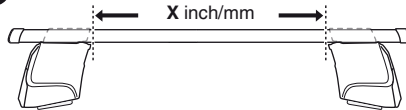

2

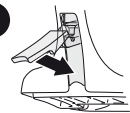

	X inch	X mm
LEXUS RX 350, 5-dr SUV, 09–	43 1/4"	1100 mm
LEXUS RX 450h, 5-dr SUV, 09–	43 1/4"	1100 mm
TOYOTA Venza, 5-dr SUV, 09–	43 1/4"	1100 mm

1

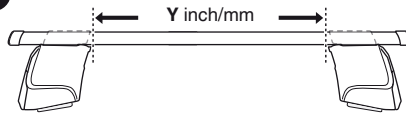
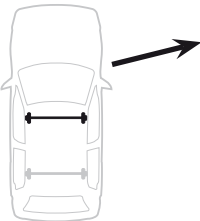

2

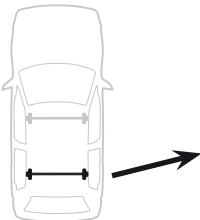

	Y inch	Y mm
LEXUS RX 350, 5-dr SUV, 09–	43 1/4"	1100 mm
LEXUS RX 450h, 5-dr SUV, 09–	43 1/4"	1100 mm
TOYOTA Venza, 5-dr SUV, 09–	43 1/4"	1100 mm

4

LEXUS RX 350, 5-dr SUV, 09–
 LEXUS RX 450h, 5-dr SUV, 09–
 TOYOTA Venza, 5-dr SUV, 09–

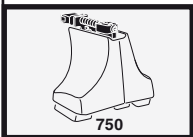
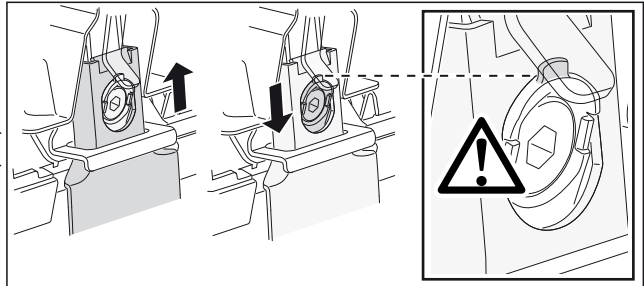
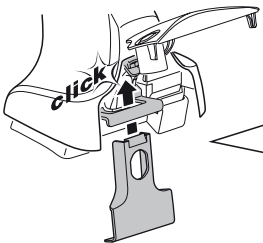
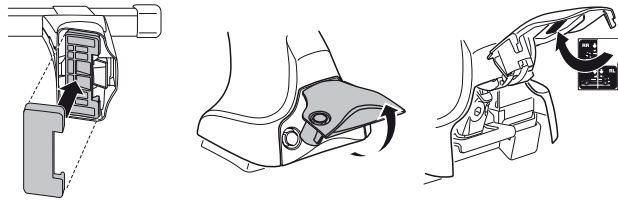
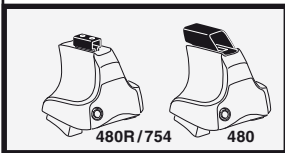
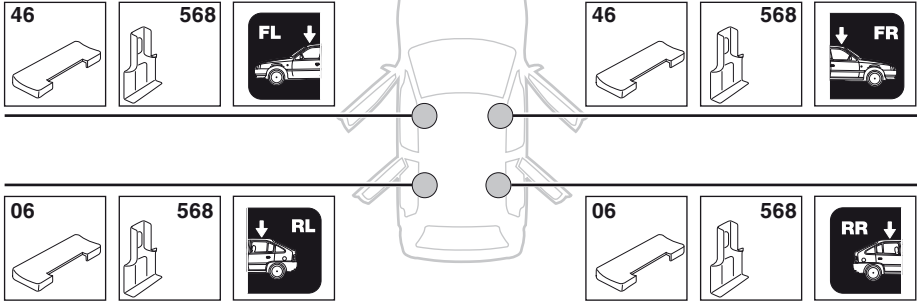

5



	X mm	Y mm	X inch	Y inch
LEXUS RX 350, 5-dr SUV, 09-	290 mm	700 mm	11 3/8"	27 1/2"
LEXUS RX 450h, 5-dr SUV, 09-	290 mm	700 mm	11 3/8"	27 1/2"
TOYOTA Venza, 5-dr SUV, 09-	290 mm	700 mm	11 3/8"	27 1/2"

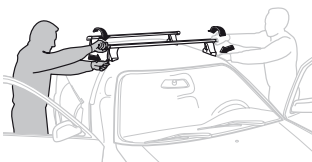
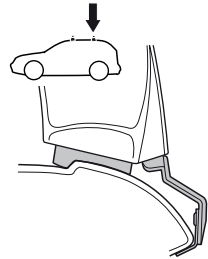
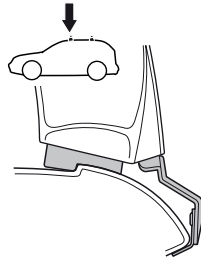
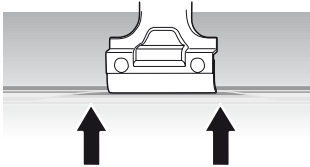
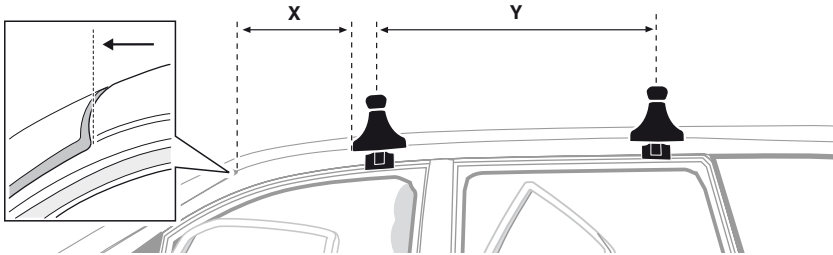

GB/US Tighten alternately
D Die Schrauben abwechselnd anziehen
F Serrer alternativement chaque côté
NL Afwisselend aan de linker- en de rechterkant aandraaien
I Alternare il serraggio delle viti
E Apretar alternativamente
PT Aperte alternadamente
S Dra åt växelvis
FIN Kierrä vuorotellen
EST Pinguldage vaheldumisi
LAT Pievelciet pamīšus
LIT Užsukinėkite pakaitomis
PL Śruby dokręcaj naprzemiennie
RU Затягивайте попеременно

CZ Pokręťta багаžníka dokręcaj dokręcaj naprzemiennie.
SK Dofahujte striedavo
SLO Privijajte izmenično.
HR Naizmjenično zategnite
HU Egymástól függetlenül szorítandó
GR Σφιγίγτε εναλλάξ
TR Dönüşümlü sıkın
中文 交替拧紧
한국어 번갈아 가며 조이십시오.
日本語 交互に締め付けてください。
ไทย ชั้้นในแบบสลับ

6

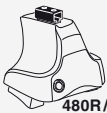

480R/754



480

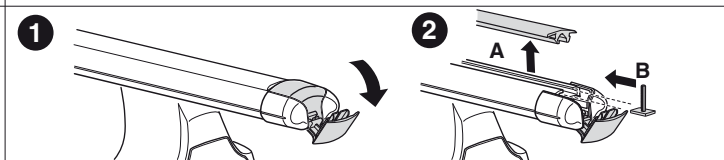
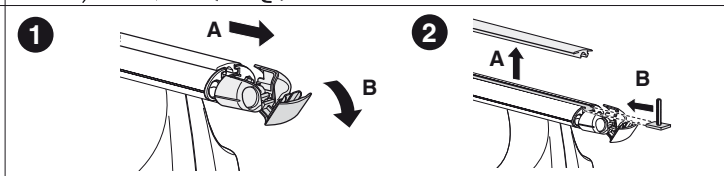
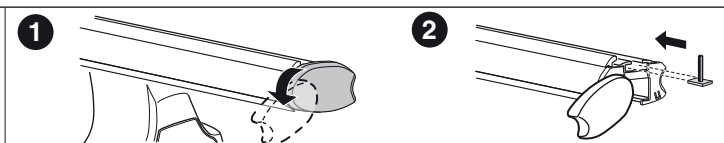
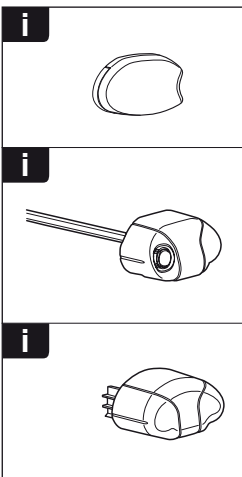
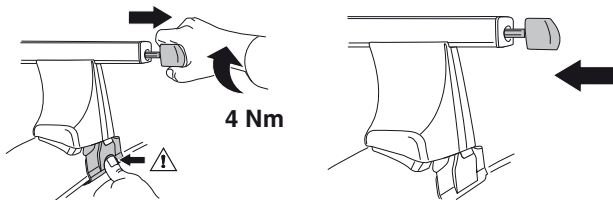
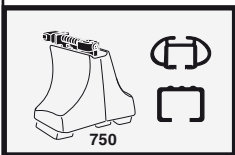
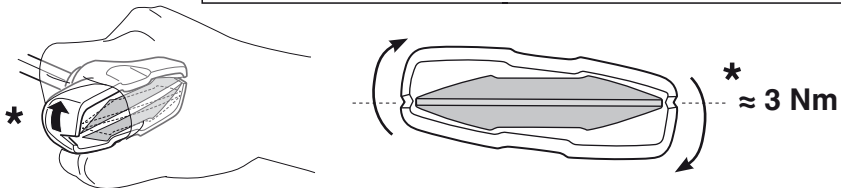
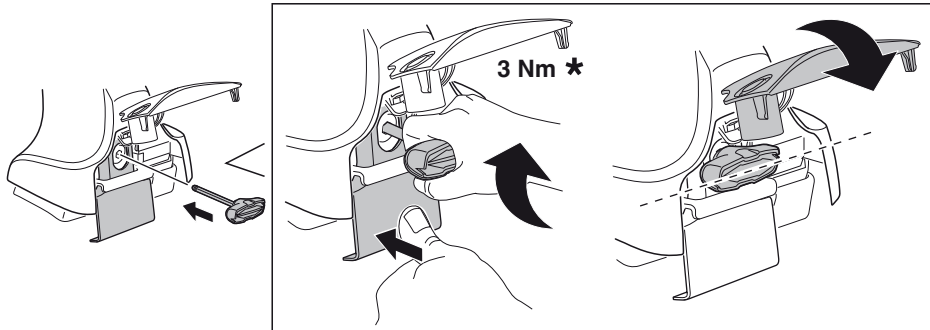

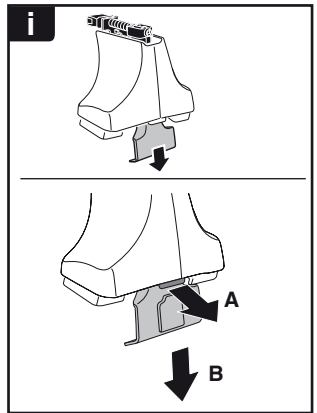
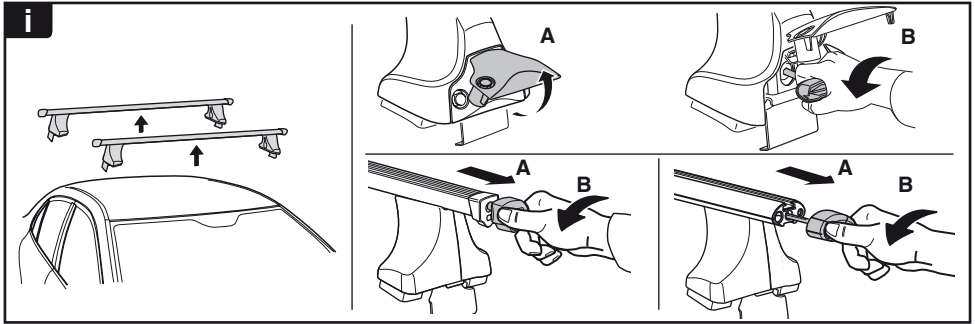

THULE
SWEDEN
**ONE
KEY
SYSTEM**



- 544 (x4)
- 596 (x6)
- 588 (x8)
- NA 510 (x10)
- EUR 452 (x12)
- ASIA



WW ▶ Thule Sweden AB, Box 69, 330 33 Hillerstorp, SWEDEN
NA ▶ Thule Inc., 42 Silvermine Road, Seymour, Connecticut 06483, USA

info@thule.com
customer.service@thule.com

www.thule.com