

Kit 1551

INFINITI G35, 4-dr Sedan, 07- (NA)

INFINITI G37, 4-dr Sedan, 09- (NA)

480R
754

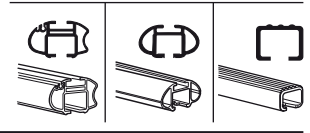
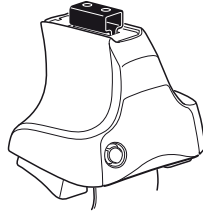

480

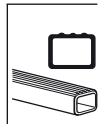
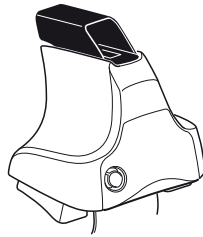

750

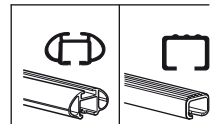
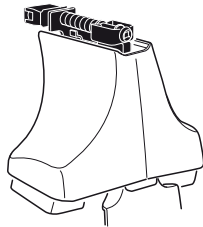

Kit



3

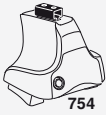

754

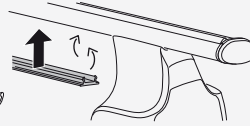
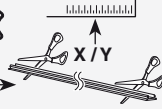

750

1

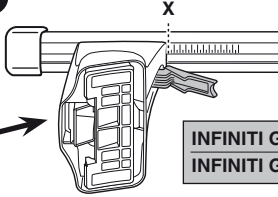

2

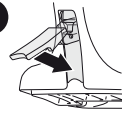

	X
INFINITI G35, 4-dr Sedan, 07- (NA)	37
INFINITI G37, 4-dr Sedan, 09- (NA)	37

1

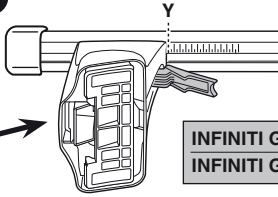

2

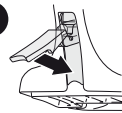

	Y
INFINITI G35, 4-dr Sedan, 07- (NA)	34,5
INFINITI G37, 4-dr Sedan, 09- (NA)	34,5



480R



480

1

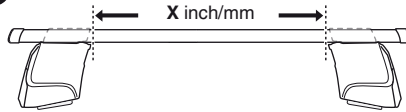

2

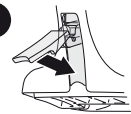

	X inch	X mm
INFINITI G35, 4-dr Sedan, 07- (NA)	40 1/4"	1021 mm
INFINITI G37, 4-dr Sedan, 09- (NA)	40 1/4"	1021 mm

1

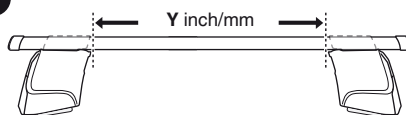

2

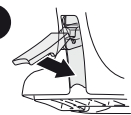

	Y inch	Y mm
INFINITI G35, 4-dr Sedan, 07- (NA)	39 1/4"	996 mm
INFINITI G37, 4-dr Sedan, 09- (NA)	39 1/4"	996 mm

4

INFINITI G35, 4-dr Sedan, 07- (NA)
 INFINITI G37, 4-dr Sedan, 09- (NA)

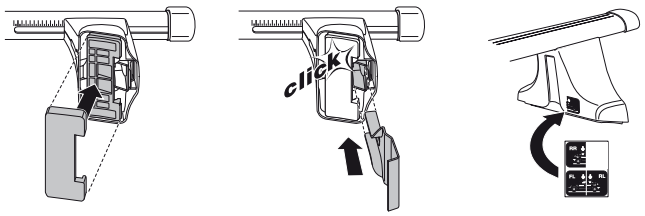
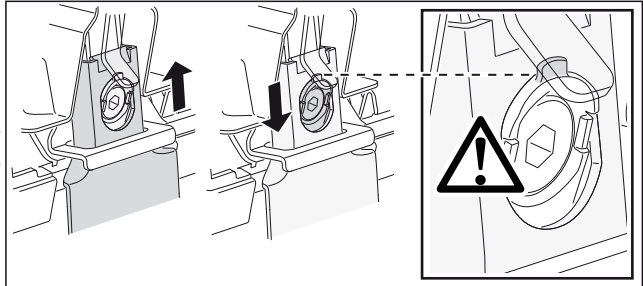
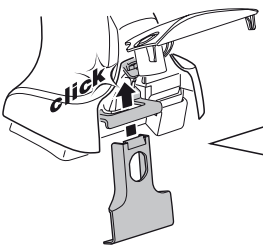
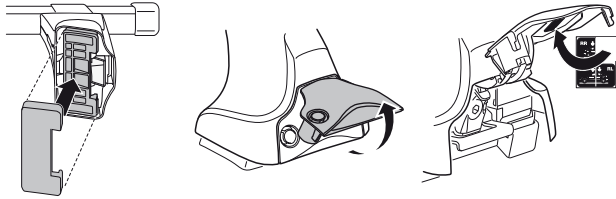
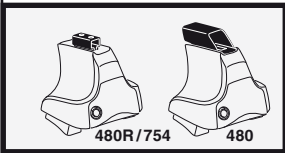
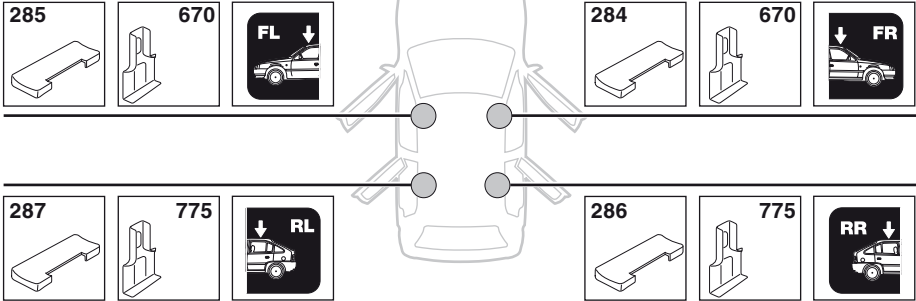

5



	X mm	Y mm	X inch	Y inch
INFINITI G35, 4-dr Sedan, 07– (NA)	270 mm	685 mm	10 1/2"	27"
INFINITI G37, 4-dr Sedan, 09– (NA)	270 mm	685 mm	10 1/2"	27"

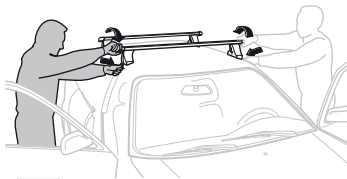
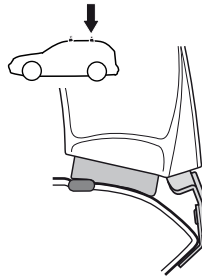
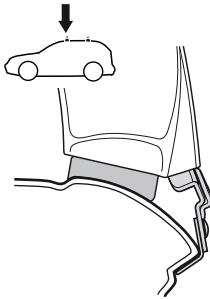
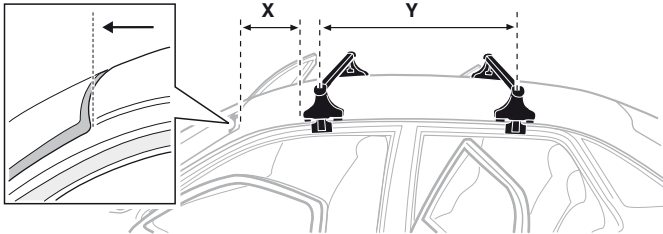

GB/US Tighten alternately

D Die Schrauben abwechselnd anziehen

F Serrer alternativement chaque côté

NL Afwisselend aan de linker- en de rechterkant aandraaien

I Alternare il serraggio delle viti

E Serrare alternativamente

PT Aperte alternadamente

S Dra åt växelvis

FIN Kierrä vuorotellen

EST Pinguldage vaheldumisi

LAT Pielvelciet pamišus

LIT Užsukinėkite pakaitomis

PL Śruby dokręcaj naprzemiennie

RU Затягивайте попеременно

CZ Pokręťta bagažníka dokręcaj dokręcaj naprzemiennie.

SK Doťahujte striedavo

SLO Privijajte izmenično.

HR Naizmjenično zategnite

HU Egymástól függetlenül szorítandó

GR Σφίγγετε εναλλάξ

TR Dönüşümlü sıkın

中文 交替拧紧

한국어 번갈아 가며 조이십시오.

日本語 交互に締め付けてください。

ไทย ชั้้นในแบบสลับ

6



480R/754



480

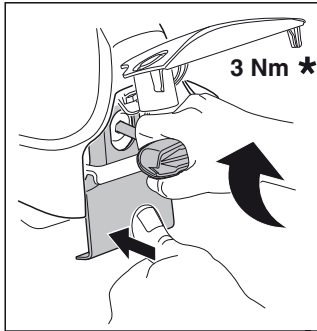

3 Nm *

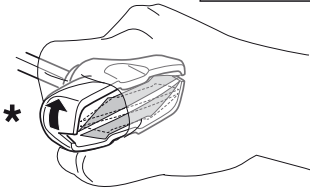
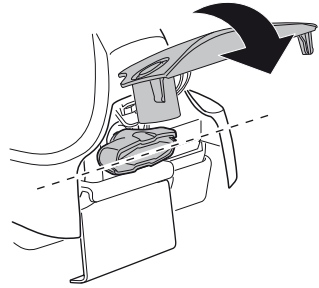

*

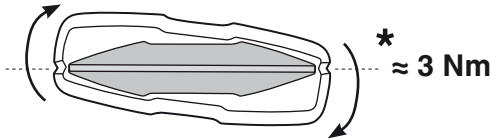

* ≈ 3 Nm



750

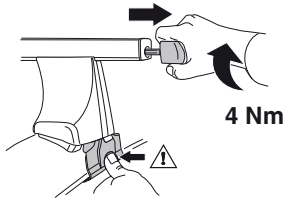

4 Nm

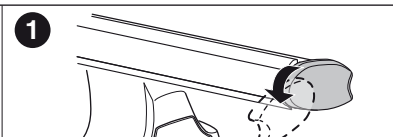
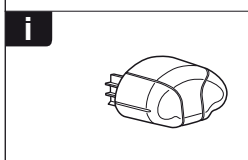
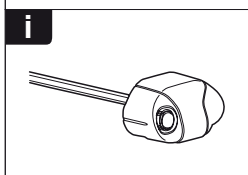
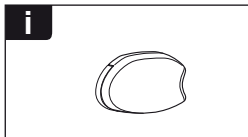
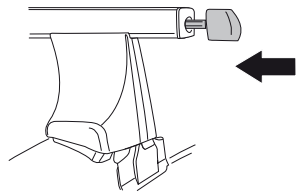

1

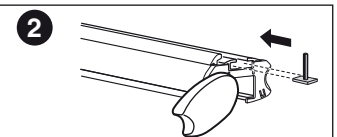

2

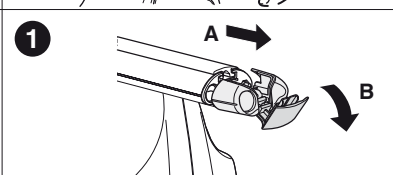

1

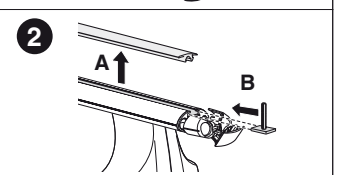

2

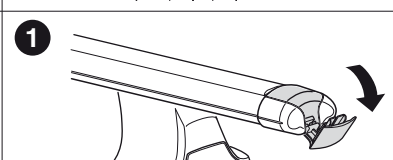

1

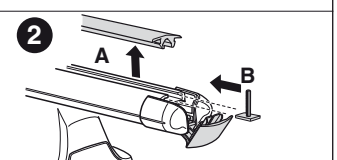

2

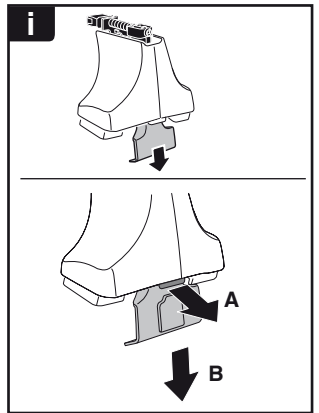

THULE
SWEDEN
**ONE
KEY
SYSTEM**



- 544 (x4)
- 596 (x6)
- 588 (x8)
- NA 510 (x10)
- EUR 452 (x12)
- ASIA 452 (x12)



WW ▶ Thule Sweden AB, Box 69, 330 33 Hillerstorp, SWEDEN
 NA ▶ Thule Inc., 42 Silvermine Road, Seymour, Connecticut 06483, USA

info@thule.com
 customer.service@thule.com

www.thule.com